

RC9150

High-End 2.4G Wireless Audio Guide System



CONTENTS

01. PRODUCT INTRODUCTION

An overview of the product line, its core innovative features, and the ideal scenarios and industries where it delivers maximum value.

02. PRODUCT FEATURES

Advanced wireless transmission technology, multi-frequency stability for uninterrupted performance, and a long-lasting battery system for extended use.

03. TECHNICAL SPECIFICATIONS

Comprehensive detailed parameters for both the transmitter and receiver units, including frequency ranges, input/output options, and power consumption data.

04. USER MANUAL

A quick-start guide covering basic setup, pairing procedures, and essential operational steps to ensure users can start using the product effortlessly.

05. ACCESSORIES

A curated selection of optional accessories, including professional microphones, high-fidelity earphones, and convenient charging solutions for all setups.

06. COMPANY INFORMATION

Insight into Shenzhen Rich Age Electronics, our core competencies, industry experience, and commitment to delivering high-quality audio and electronic solutions.

01 PRODUCT INTRODUCTION



The RC9150 transmitter combines sleek industrial design with robust build quality, ensuring reliable performance in the most demanding professional environments, from large conferences to industrial site tours.

The RC9150 is the flagship 100-channel 2.4G wireless audio guide system, offering unmatched flexibility and reliability for professional events, making it the ultimate choice for guided tours, conferences, and factory visits.

100 Channels Flexibility

Ideal for large-scale, multi-group events and simultaneous interpretation systems.

20mW High Output Power

200m open-area range with strong building penetration for reliable long-distance transmission.

Extended Battery Life

15 hours for transmitter, 40 hours for receiver on a single charge for all-day use.

User-Centric Design

One-key channel sync and shutdown for efficient, hassle-free operation by any user.

01 PRODUCT INTRODUCTION



Seminar & Training

Facilitate clear communication in educational and corporate training environments, ensuring every participant captures key information effortlessly.



Guided Tour & Museum Guide

Enhance visitor experiences in museums, galleries, and scenic spots with crystal-clear audio, allowing for immersive and informative exploration.



Major Conference & Interpretation

Seamlessly support multi-language events with secure, interference-free channels, ensuring accurate and timely delivery of every speech.



Factory Tour & Corporate Visits

Provide professional and clear explanations during site inspections and client visits, even in noisy industrial or large facility environments.

02 PRODUCT FEATURES



Professional wireless tour guide system with premium build quality and ergonomic design.



Global 2.4GHz ISM Band

Utilizes the unlicensed 2402-2480MHz frequency band, ensuring worldwide regulatory compatibility and robust anti-interference against other wireless devices for stable operation.



Impressive 200m Open-Area Range

Delivers a stable, uninterrupted audio transmission up to 200 meters in open spaces, with excellent signal penetration through walls and obstacles for versatile use in any venue.



Hi-Fi Fidelity & Active Noise Cancellation

Features a 100dB signal-to-noise ratio (SNR) and ≥ 30 dB digital noise cancellation, eliminating background hiss for crystal-clear, natural, and immersive voice reproduction.

02 PRODUCT FEATURES

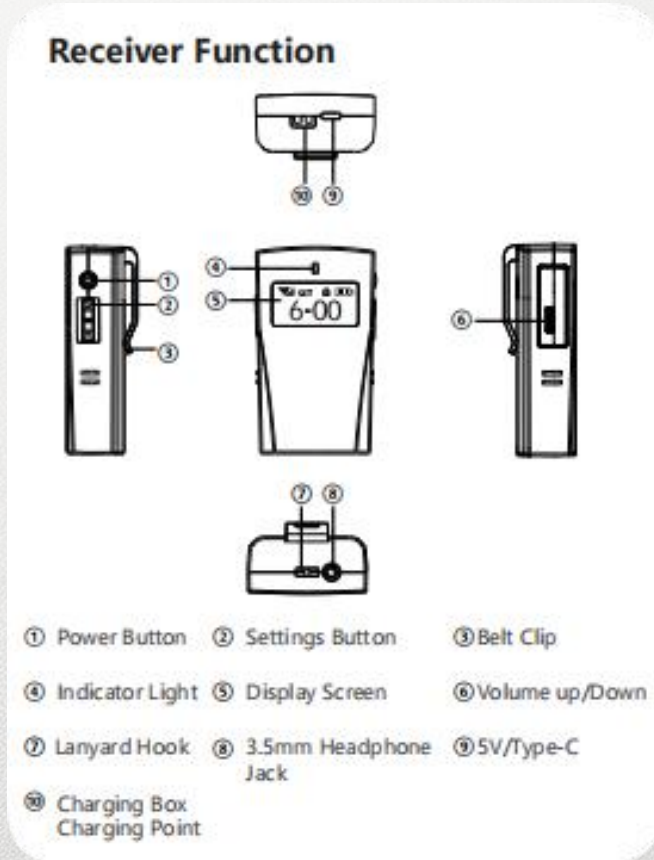

A detailed line diagram of the main transmitter, showcasing the intuitive button layout and interface that enables seamless control over the entire system.

☂ Multi-Frequency Stability & Security

100 Encrypted Channels: 100 PLL synthesized channels eliminate cross-talk, with intelligent encryption preventing eavesdropping. The system maintains reliability even in high Wi-Fi traffic, dense urban, or large venue environments.

☀ Effortless Operation

One-Button Control: Sync all receivers and vice transmitters with a single press. A triple-click on the main transmitter's power button instantly shuts down all connected devices, streamlining setup and teardown.

02 PRODUCT FEATURES



Removable & Interchangeable Batteries

Equipped with a 3.7V 1800mAh rechargeable lithium battery that is easily removable and interchangeable, enabling non-stop operation with spare batteries for uninterrupted workflow.



All-Day Battery Life

Delivers up to **15 hours** of talk time for the transmitter and an exceptional **40 hours** of listening time for the receiver, easily covering a full day of professional use.



Type-C Fast Charging

Features a universal Type-C port for hassle-free charging. A full charge takes just 2-3 hours, ensuring minimal downtime between shifts or sessions.



HOT

ACCESSORIES SET



Transmitter



microphone



sling



Receiver

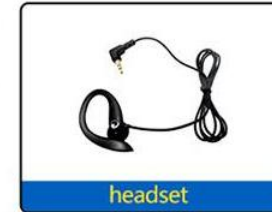

headset



charger



One charge ten chargers



Charging case

A versatile ecosystem of charging solutions, from single-unit to multi-bay chargers, ensures you can power your devices efficiently anywhere, anytime.

03 TECHNICAL SPECIFICATIONS

OPERATING FREQUENCY

2.4 GHz (ISM Band) for both Transmitter and Receiver, ensuring stable and interference-free connection.

CHANNELS & TRANSMISSION

100 selectable channels with a transmission distance of 1-200 meters in open areas, providing versatile coverage.

POWER & SIGNAL QUALITY

20 mW (16 dB) output power paired with an exceptional 100 dB Signal-to-Noise Ratio for crystal-clear performance.

BATTERY CAPACITY

Equipped with a 3.7V / 1800mAh removable Li-battery and a universal Type-C charging interface for easy recharging.

WORKING DURATION

Up to ~15 hours for the Transmitter and an extended ~40 hours for the Receiver on a single full charge.

DIMENSIONS

Compact form factor measuring 92.8 x 53 x 25.5 mm for both units, making them highly portable and easy to handle.

WEIGHT

An ultra-lightweight design of approximately 97.5 grams, ensuring minimal fatigue during prolonged use in the field.

CONFIGURATION & SUPPORT

Specifications are subject to update. Contact our team directly to explore tailored configurations for specific use cases.

04 USER MANUAL (Quick Guide)

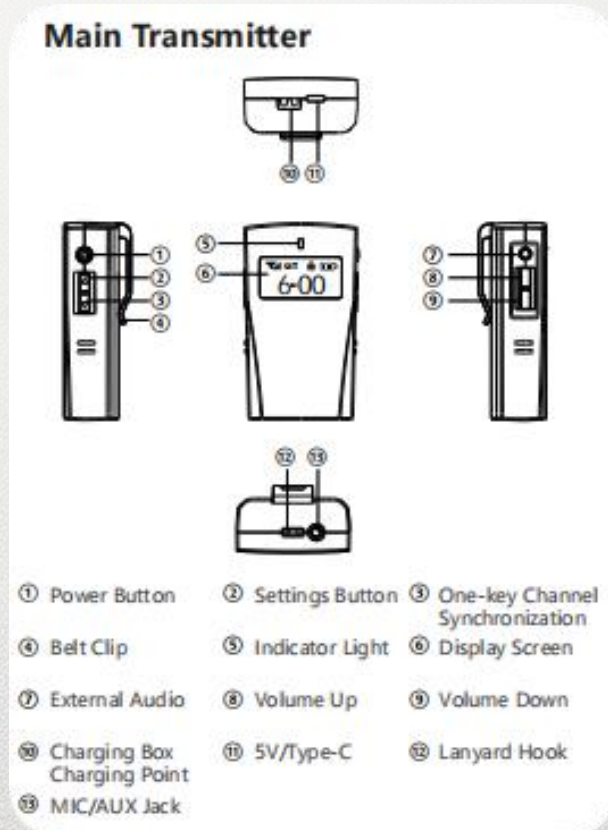

Refer to the diagram for button locations. The RC9150 features an intuitive layout for quick access to all core functions.

Power On/Off

Press and hold the Power Button for 3 seconds to turn the device on or off safely.

Volume Adjustment

Use the Volume Up (▲) and Volume Down (▼) buttons to control audio levels easily.

Channel Selection

Click right ▲ to unlock, left ▲/▼ to select, long-press right ▲ to confirm your choice.

One-Key Sync

On the main transmitter, long press the right ▼ button for 2 seconds to automatically synchronize all paired devices to the same channel.

One-Key Shutdown

On the main transmitter, quickly press the Power Button three times to initiate a system-wide shutdown of all connected units.

05 ACCESSORIES

Microphone	Headset		Net weight: 30g;
	Collar		Net weight: 20g;
Earphone	Standard		Net weight: 14g;
	Outside D-type earphone		Net weight: 17g
	Headphone		Net weight: 45g
Accessory ②	Type	Picture	Specification
Charger	1 cord		Charging 1 device at a time; N.W.: 0.04kg
	10 cords		Charging 10 devices at a time; N.W.: 0.49kg; Size: 150*65*39mm
	Simple charger with 60-slot		Very safe chargers, one time can charge 60 pcs, includes 60 charging cables
	32 slots		Charging 32 devices at a time; Waterproof; Cross body Suitcase N.W.: 4.8kg Size: 425*320*183mm
	40 slots		Charging 40 devices at a time; 4 wheels, Waterproof; Detachable universal wheel N.W.: 5.77kg; Size: 520*320*180mm
	60 slots		Charging 60 devices at a time; Waterproof; 2 wheels. N.W.: 10.57kg; Size: 665*405*250mm

Comprehensive accessory options to suit diverse operational needs, ensuring optimal audio quality and user comfort in any setting.



Microphones for Transmitters

Standard Headset Mic (30g)

Lightweight design engineered for clear, focused voice pickup in various environments.

Discreet Collar Mic (20g)

Minimalist lapel microphone for completely hands-free operation and unobtrusive wear.



Earphones for Receivers

Standard (14g)

Comfortable in-ear fit for extended use with natural sound reproduction.

D-Shape (17g)

Ergonomic design that offers a secure, stable fit for active movement.

Headset (45g)

Over-the-head style for maximum comfort during long listening sessions.

05 ACCESSORIES



Our charging solutions are engineered for durability and efficiency, with rugged aluminum alloy frames and waterproof designs to protect your valuable equipment in any environment.

Charging Solutions

Scalable Options: From compact 1-to-10 chargers for small groups to robust 32-slot aluminum alloy cases, we have you covered. Our wheeled, detachable 40, 50, and 60-slot cases offer waterproof protection and capacity for up to 60 devices (2 transmitters + 48 receivers for the 50-slot model), perfect for large events.

Portable Storage & Transport— Choose from 3, 10, 20, or 52-slot cases for convenient, non-charging storage and secure transit of your devices, ensuring your equipment is always event-ready.

06 COMPANY INFORMATION



Our state-of-the-art manufacturing facility integrates advanced production lines and quality control systems to ensure precision and consistency in every product.

12+ Years of Expertise

Dedicated experience in audio R&D and manufacturing, mastering core technologies for high-performance audio solutions.

400+ Professionals & R&D

A skilled workforce of over 400, including a specialized team of 30+ engineers, driving continuous innovation and product excellence.

213,000 m² Mega Factory

Equipped with fully automated and advanced production lines to ensure efficiency, scalability, and the highest manufacturing standards.

60+ Patents & Certifications

ISO9001, CE, RoHS, BSCI, 3C, EMC/LVD/RED certified. Committed to independent R&D with a strong IP portfolio.

OUR STRENGTHS: WHY CHOOSE RICH AGE?

Owned Manufacturing Facility

Our vast 213,000 m² factory ensures large-scale production capacity, strict quality control, and the ability to fulfill bulk orders efficiently, delivering reliability at every step.

Strong R&D Capability

Backed by 30+ R&D engineers and a portfolio of 60+ patents, we continuously innovate to deliver cutting-edge OEM/ODM solutions tailored to diverse market needs.

Proven Industry Expertise

Over 12 years of focused experience in the audio industry have honed our craft, ensuring we design and manufacture reliable, high-performance wireless audio equipment every time.

Comprehensive Global Certifications

Adherence to ISO9001, CE, RoHS, and other stringent international certifications guarantees product safety, quality, and seamless compliance with global import regulations for hassle-free market entry.

Customer-Centric Support & Service

We prioritize your success with one-on-one professional consulting, comprehensive sample support, and responsive after-sales service, ensuring a smooth and collaborative partnership from start to finish.

07 COMPANY STRENGTH



Our well-equipped manufacturing base showcases our commitment to quality control and efficient production processes, ensuring reliable delivery for global clients.



INTEGRATED HIGH-TECH ENTERPRISE

We specialize in R&D, design, and manufacturing of wireless tour guide systems, church translation headphones, and museum audio guide equipment, delivering professional audio solutions for diverse scenarios.



SCALE & INFRASTRUCTURE EXCELLENCE

Our 8,500m² factory houses 10 PCBA SMT lines, 4 assembly lines, and 2 packaging lines. Backed by 400+ skilled employees and 30+ R&D professionals, we ensure precision and scalability in every production stage.



GLOBAL MARKET PENETRATION

Our products are exported to over 100 countries and regions, including the USA, Europe, Southeast Asia, the Middle East, and the Pacific, building a strong international reputation for reliability and innovation.

08 CONTACT US

For inquiries about the RC9150 wireless tour guide system, wholesale pricing, or OEM/ODM customization, please reach out using the contact details below. We are dedicated to providing prompt and professional responses to all your questions.



Website

www.richitek.com



Email

info@richitek.com



Phone

+86-13825295213 / +86-18922879583



Address

3F, D1 Building, Yiyue Qingchuang Industrial Park, 2-29 Yongyue Road, Baishixia Community, Fuyong Street, Bao'an District, Shenzhen, China

Thank You

Professional Wireless Audio Equipment - Delivering Pristine Sound

